

# Soils Map

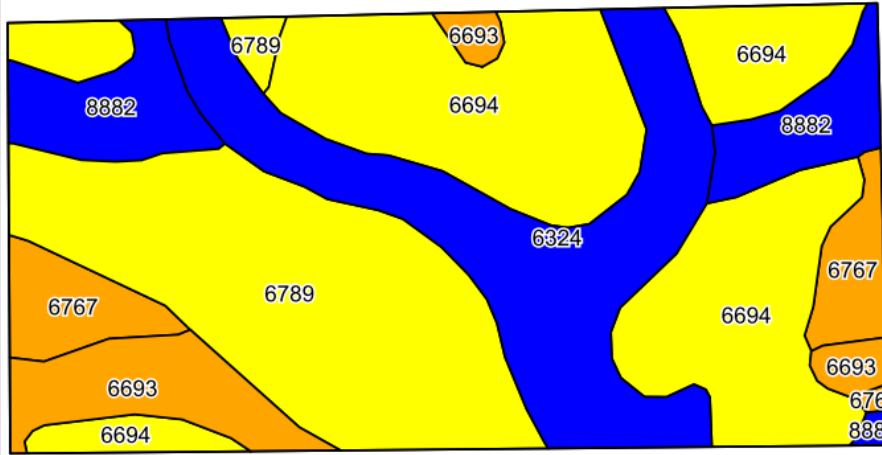

©2023 AgriData, Inc.

Soils data provided by USDA and NRCS.

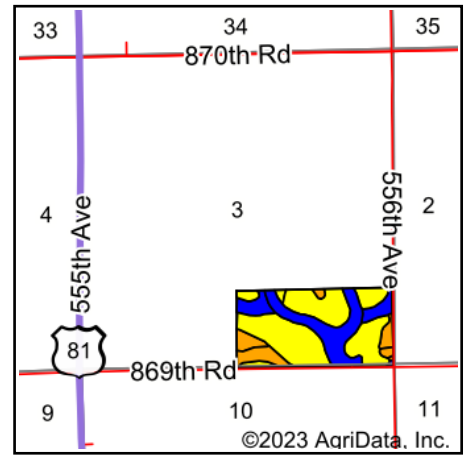

©2023 AgriData, Inc.

State: **Nebraska**  
 County: **Pierce**  
 Location: **3-28N-1W**  
 Township: **Eastern**  
 Acres: **80**  
 Date: **6/23/2023**



Maps Provided By:



Area Symbol: NE139, Soil Area Version: 21

Code	Soil Description	Acres	Percent of field	Non-Irr Class Legend	Non-Irr Class *c	Irr Class *c	*n NCCPI Overall	*n NCCPI Corn	*n NCCPI Small Grains	*n NCCPI Soybeans
6694	Crofton-Nora complex, 6 to 11 percent slopes, eroded	25.87	32.3%		IVe	IVe	65	60	41	64
6789	Crofton-Nora complex, 11 to 17 percent slopes, eroded	21.00	26.2%		IVe		61	58	39	61
6324	Coleridge silty clay loam, 0 to 2 percent slopes, occasionally flooded	15.37	19.2%		IIw	IIw	80	79	49	73
8882	Hord-Hobbs silt loams, 0 to 6 percent slopes	7.11	8.9%		Ile	Ile	71	62	49	71
6693	Crofton-Nora complex, 2 to 6 percent slopes, eroded	5.79	7.2%		IIIe	IIIe	68	62	42	68
6767	Nora silty clay loam, 6 to 11 percent slopes	4.86	6.1%		IIIe	IVe	74	62	47	74
Weighted Average					3.30	*-	*n 68.1	*n 63.6	*n 43.2	*n 66.5

\*n: The aggregation method is "Weighted Average using all components"

\*c: Using Capabilities Class Dominant Condition Aggregation Method

\*- Irr Class weighted average cannot be calculated on the current soils data due to missing data.

Soils data provided by USDA and NRCS.