

RODNEY BARTSCH  
41.17 ACRES  
#201604625

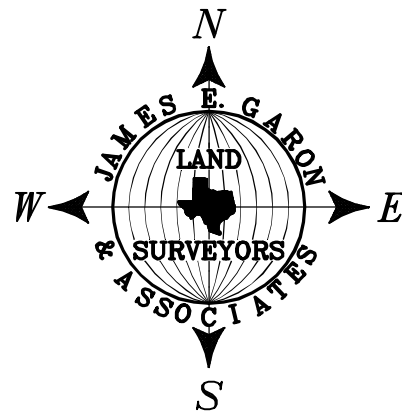

SCALE: 1"= 60'

BEARINGS SHOWN ARE GRID NORTH BASED ON  
GPS OBSERVATIONS FOR TEXAS STATE PLANE  
COORDINATE SYSTEM "CENTRAL ZONE" NAD83.

**LEGEND**

- 1/2" REBAR FOUND (UNLESS NOTED)
- 1/2" REBAR SET W/CAP  
STAMPED J.E. GARON RPLS 4303
- ⊙ IRON ROD W/CAP FOUND
- ⦿ 1" PIPE FOUND (UNLESS NOTED)
- X— WIRE FENCE
- POWER POLE
- E— OVERHEAD ELECTRIC LINE
- D— DOWN GUY
- Ⓢ TELEPHONE PEDESTAL

EDITH GEORGE  
5.56 ACRES  
#202012454

11.565 Ac.  
MARGARETTE KAYLOR  
11.66 ACRES  
2236/363

S 86°57'28" W 860.41'

CARMEN HILL LANE

FOURTH TRACT  
EASEMENT  
2236/363 (151/307)

KEN RAY ROBERTS  
11.162 ACRES  
2026/455

TO THE OWNERS, LIENHOLDERS AND TITLE COMPANY

THE UNDERSIGNED DOES HEREBY CERTIFY THAT THIS SURVEY WAS THIS DAY MADE ON THE GROUND OF THE PROPERTY DESCRIBED HEREON AND IS CORRECT, AND THAT THERE ARE NO DISCREPANCIES, SHORTAGES IN AREA, BOUNDARY LINE CONFLICTS, ENCROACHMENTS, OVERLAPPING OF IMPROVEMENTS, VISIBLE UTILITY LINES OR ROADS IN PLACE, EXCEPT AS SHOWN HEREON, AND THAT SAID PROPERTY HAS ACCESS TO AND FROM A DEDICATED ROADWAY, EXCEPT AS SHOWN HEREON.

THE UNDERSIGNED DOES FURTHER CERTIFY THAT THE PROPERTY DESCRIBED HEREON IS LOCATED IN ZONE "X" AND IS NOT WITHIN A 100-YEAR FLOOD HAZARD AREA AS IDENTIFIED BY THE FEDERAL EMERGENCY MANAGEMENT AGENCY FLOOD INSURANCE RATE MAP, PANEL NO. 48021C0350F EFFECTIVE MAY 9, 2023.

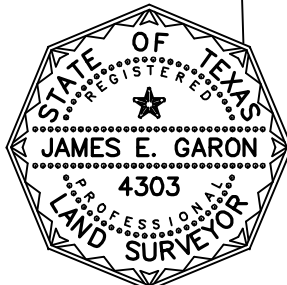

James E. Garon  
NOVEMBER 14, 2024

REFERENCE: G.F. NO.:  
ADDRESS: 122 CARMEN HILL LANE, BASTROP, TEXAS  
LEGAL DESCRIPTION: 11.565 ACRES, TERESA HIGHSMITH SURVEY A-193,  
BASTROP COUNTY, TEXAS.

FIELD BOOK: B-739/54-59  
FILE: S:\Counties\Bastrop\Surveys\Teresa Highsmith A-193\61724.dwg

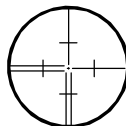

**JAMES E. GARON & ASSOC.**  
LAND SURVEYORS & CIVIL ENGINEERS  
Firm Reg. #10058400 & F-20386  
185 McAllister Road  
Bastrop, Texas 78602  
(512) 303-4185  
jgaron@austin.rr.com  
www.jamesegaron.com